

FACILITIES MANAGEMENT

Saunders Building

PO Box 1700 STN CSC Victoria BC V8W 2Y2 Canada

Title: 24-06263 Petch, Elliot, & Cunningham Chiller Replacement

Location impacted: Petch, Cunningham

Description: Crane Lift / Partial Building Closure

Facilities Management and Caird Mechanical will be replacing the first of two chillers on the roof of the Petch Building on Friday, March 21st.

This will be a full day process during which the old chiller will be lifted off the roof from the north side of the building and its replacement will be lifted into place using the same crane.

Due to the significant weight of this chiller and the act of lifting it above the roof, we have chosen to close the Petch Building directly under the path of the crane lift, as a precaution.

This will close:

- All restrooms on the north-west end of the building
- Several offices in Petch (see attached plans)
- A section of the far west end of the Petch corridor (all levels)
- The Petch-Cunningham connector (all levels)

If your office is among those affected by this closure, I sincerely apologize for the disruption. Please try to make sure that you have anything you need to work in an alternate location next Friday. If you absolutely need to access your office, it may be possible in between crane lifts. Please reach out to me to coordinate a time.

Alternate restrooms are available at the centre of the Petch Building on all levels.

Time frame: Friday March 21st, 2025 – All day

FMGT contact: Jen Miley, Project Manager

Email address: jmiley@uvic.ca



Facilities Notice

FACILITIES MANAGEMENT

Saunders Building

PO Box 1700 STN CSC Victoria BC V8W 2Y2 Canada

Phone: 250-661-0981



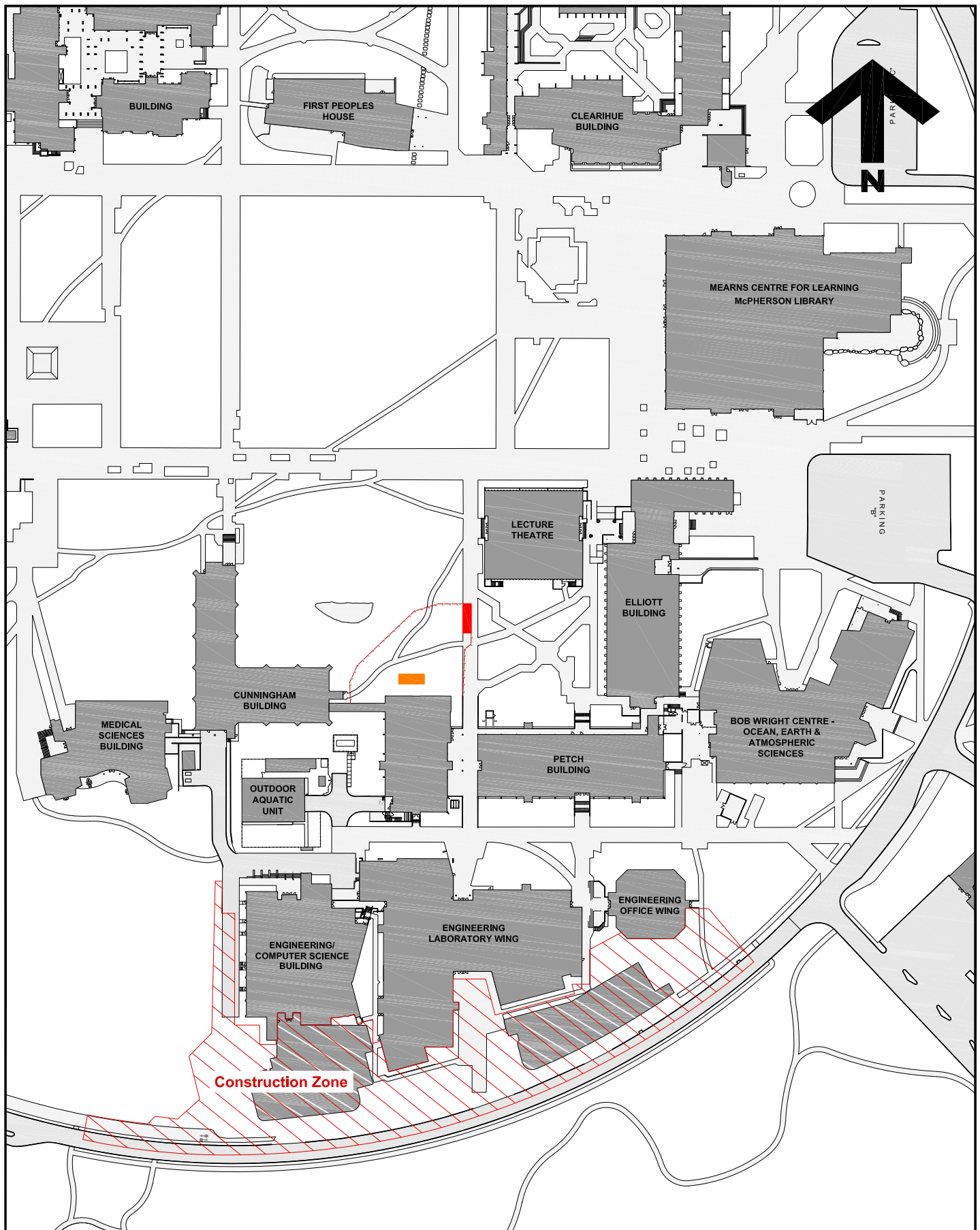

**University
of Victoria**

Facilities Management

Notes:

- Truck Location
- Crane Location
- Temporary Barrier

Title:

**Petch Chiller Replacement
Site Plan**

Date:

13 March 2025

Scale:

1:2000

Drawn By:

JW

Project Number:

24-06263

Drawing No.

SK1

This drawing is for reference only. All site dimensions and conditions must be field-verified and reflected in all drawings submitted to UVic. The UVic title block is for FMGT use only. Modifications made to this document must be represented by the modifiers own title block. Any discrepancies found in UVic drawings must be communicated to UVic FMGT Project Manager assigned to the Project.

Title:
**Petch Chiller Installation
Cunningham / Petch
Corridor Closures
Level 0**

Date: **13 March 2025**
Scale: **1:650**
Drawn By: **JW**
Project Number: **24-06263**
Drawing No. **SK2**

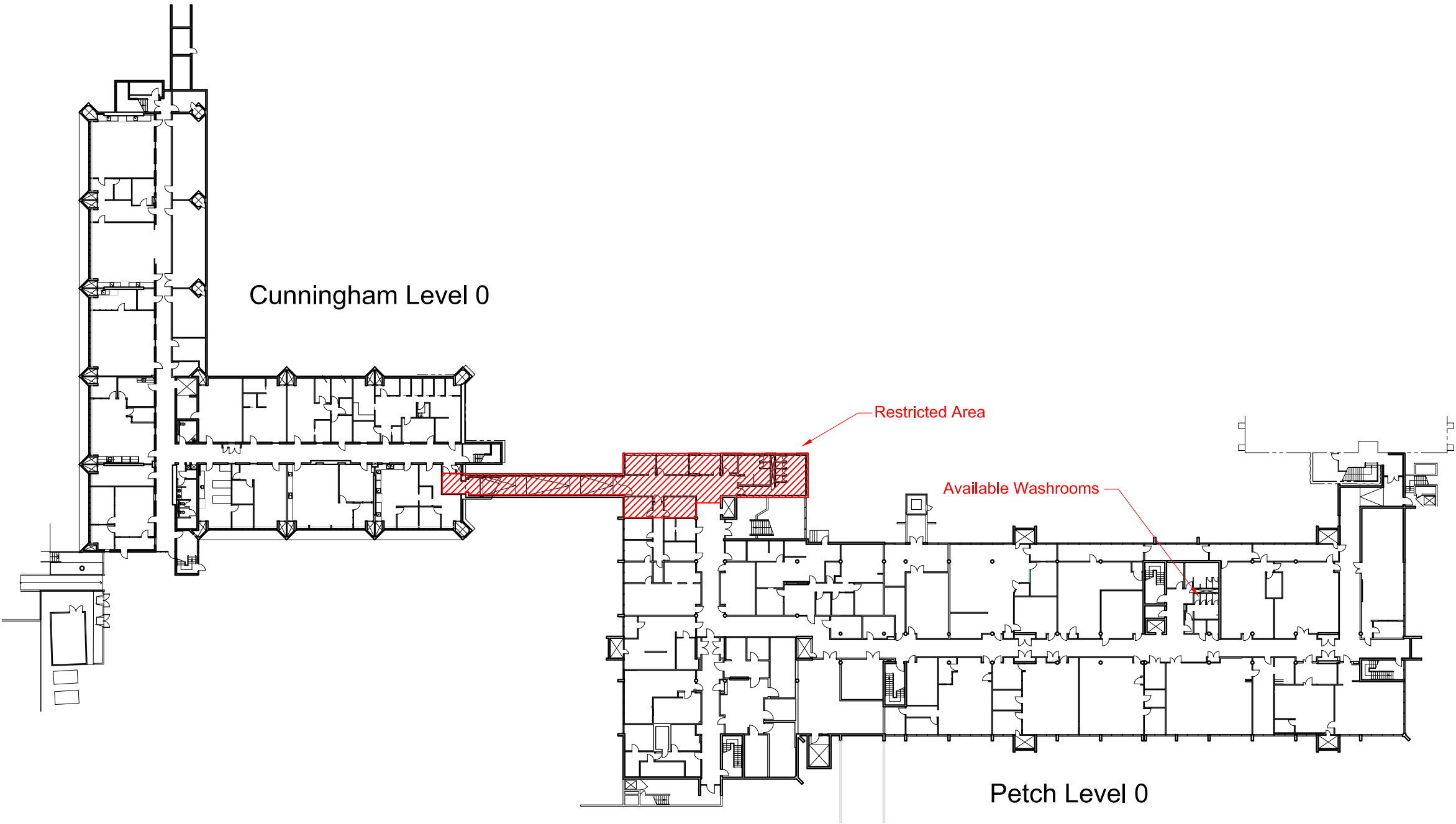
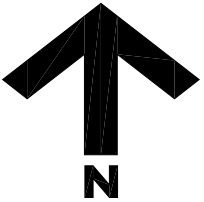

Notes:

This drawing is for reference only. All site dimensions and conditions must be field-verified and reflected in all drawings submitted to UVic. The UVic title block is for FMGT use only. Modifications made to this document must be represented by the modifiers own title block. Any discrepancies found in UVic drawings must be communicated to UVic FMGT Project Manager assigned to the Project.

Title:
**Petch Chiller Installation
Cunningham / Petch
Corridor Closures
Level 1**

Date: **13 March 2025**
Scale: **1:650**
Drawn By: **JW**
Project Number: **24-06263**
Drawing No. **SK3**

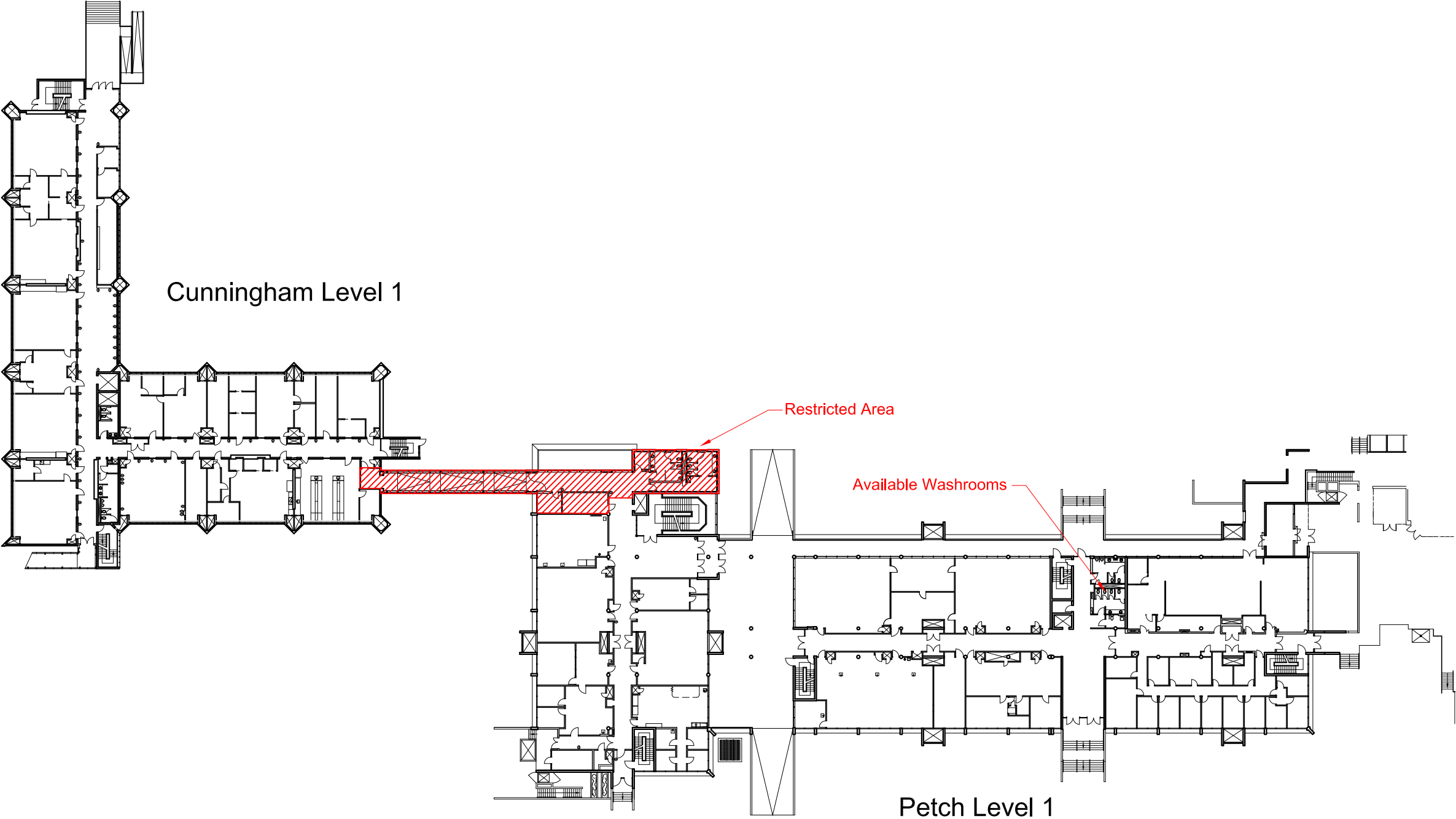
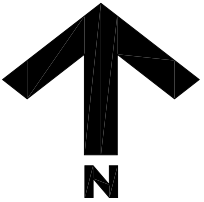

Notes:

This drawing is for reference only. All site dimensions and conditions must be field-verified and reflected in all drawings submitted to UVic. The UVic title block is for FMGT use only. Modifications made to this document must be represented by the modifiers own title block. Any discrepancies found in UVic drawings must be communicated to UVic FMGT Project Manager assigned to the Project.

Title:
**Petch Chiller Installation
Cunningham / Petch
Corridor Closures
Level 2**

Date:	13 March 2025
Scale:	1:650
Drawn By:	JW
Project Number:	24-06263
Drawing No.	SK4

