

FACILITIES MANAGEMENT

Saunders Building

PO Box 1700 STN CSC Victoria BC V8W 2Y2 Canada

Title:	Petch - East Loading Bay Use and Lab Casework Delivery
Location:	Petch - East Loading Bay (also known as BWC Loading Bay)
Description:	<p>Facilities Management is working with Onal Construction Ltd. and Kingsview Construction to undertake renovations to PCH 246 and ELL 245. Lab casework is scheduled for delivery at the Petch East Loading Bay (BWC Loading Bay).</p> <p>Please see attached plans for location of truck to be parked at the loading bay and routes of delivery through the building for the casework.</p> <p>Note: the elevator L25 will be used intermittently to move casework to the 2nd floor and may cause some short delays in the use of the elevator.</p> <p>FMGT apologizes for any inconvenience this work may cause.</p>
Time frame:	Monday, April 4, 2022 from 8:30am to 5:00pm approximately
FMGT contact:	Kim Frechette, Project Manager
Email address:	kfrechette@uvic.ca
Phone:	250-516-2922

See Revised Version



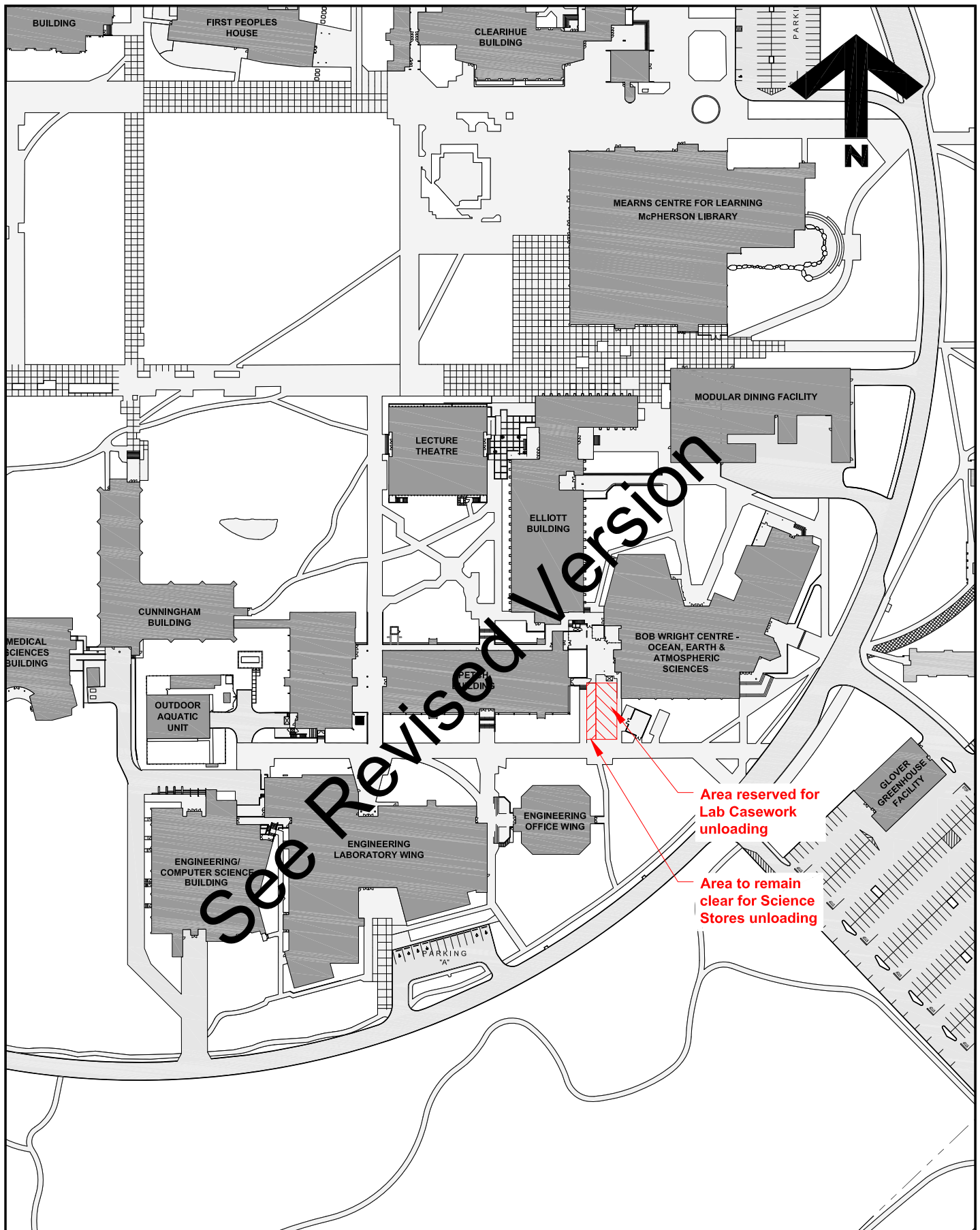

**University
of Victoria**

Facilities Management

Notes:

Title:

**Petch / Elliott
Loading Bay Options**

Date: **25 March 2022**

Scale: **1:1000**

Drawn By: **JW**

Project Number: **F04514/15**

Drawing No. **SK1**

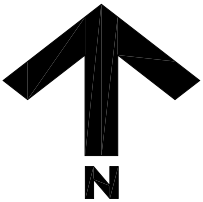
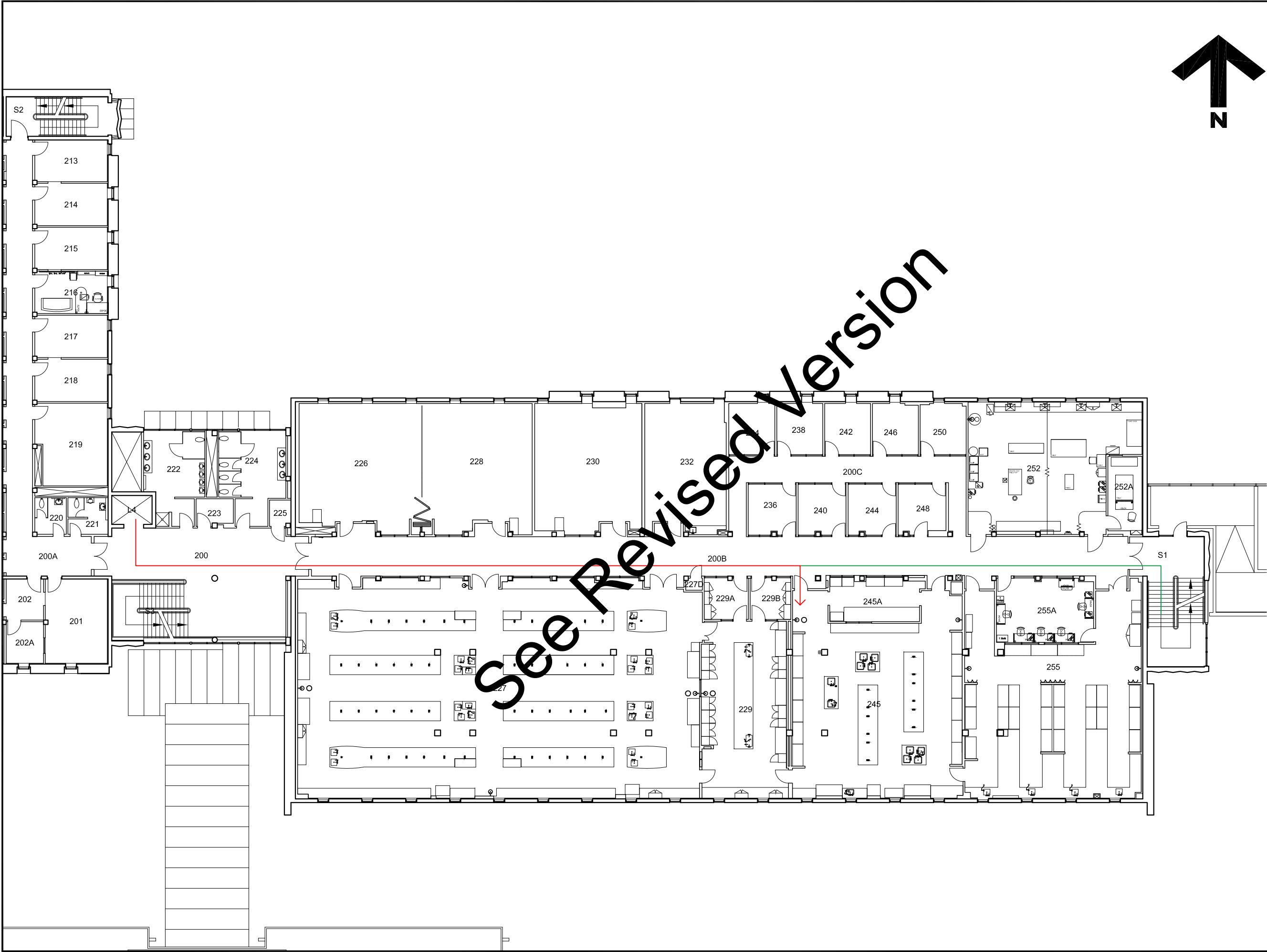

University
of Victoria

Facilities Management

Notes:

- ← Route from Elevator
- ← Route from Stair

Title:
Elliott Building
Level 2
Casework Move Plan

Date: 25 March 2022
Scale: 1:250
Drawn By: JW
Project Number: F04514/15
Drawing No. SK2

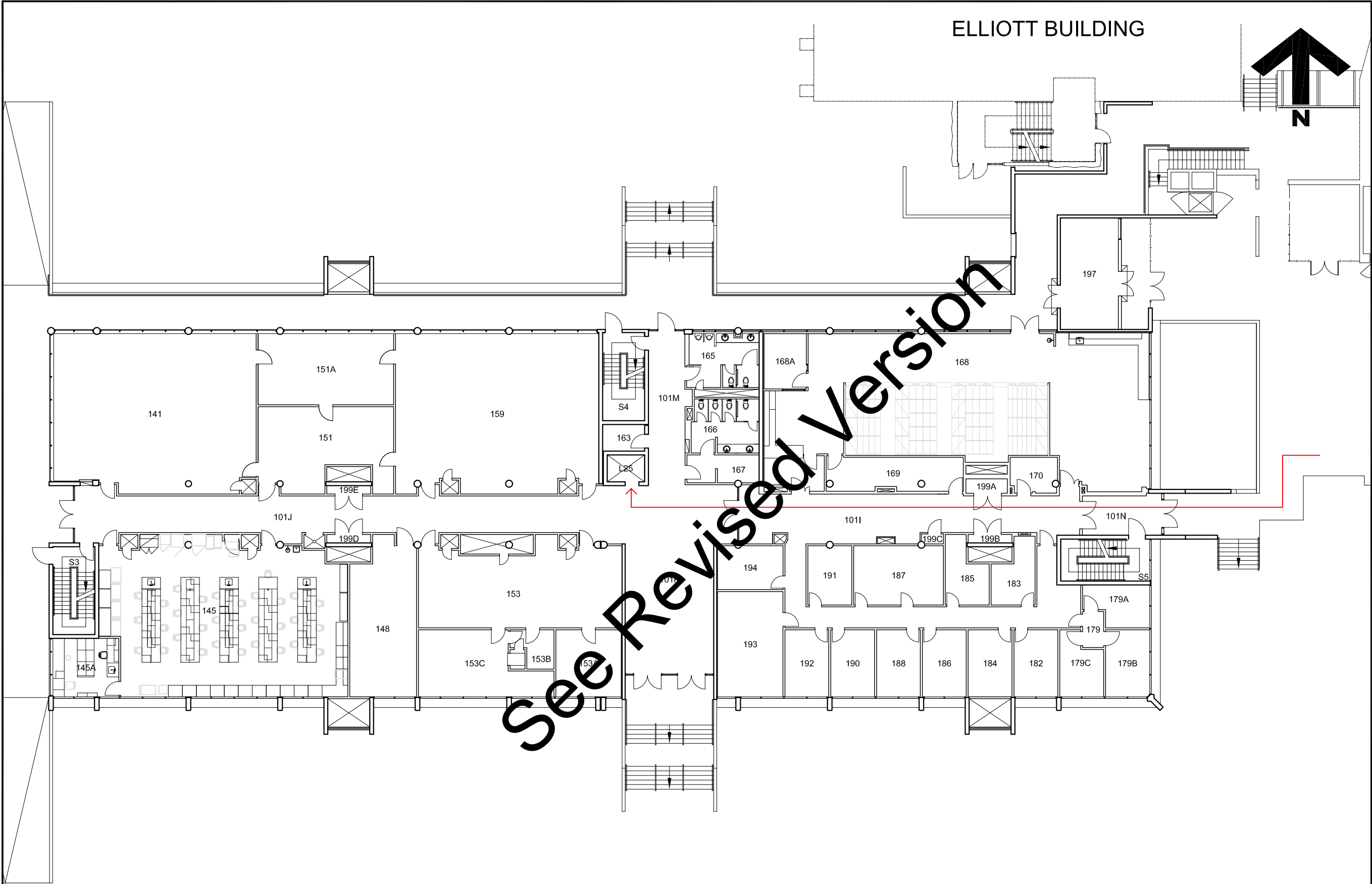

University
of Victoria

Facilities Management

Notes:

← Route from
Loading Bay

Title:
**Petch Building
Level 1
Casework Move Plan**

Date: 25 March 2022
Scale: 1:250
Drawn By: JW
Project Number: F04514/15
Drawing No. SK3

Notes:

← Route from Elevator

Title:
**Petch Building
Level 2
Casework Move Plan**

Date: **25 March 2022**
Scale: **1:250**
Drawn By: **JW**
Project Number: **F04514/15**
Drawing No. **SK3**

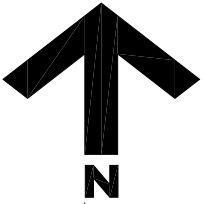

ELLIOTT BUILDING

