

FACILITIES MANAGEMENT

Saunders Building

PO Box 1700 STN CSC Victoria BC V8W 2Y2 Canada

Title:	Clearihue Building Corridor Refresh – PHASE 2
Location:	Clearihue – Phase 2 – Corridors (maps attached)
Description:	<p>Facilities Management and Aral Construction will be commencing the CLE Corridor Refresh - Phase 2 on Thursday, November 28, 2019.</p> <p>This includes the following:</p> <ul style="list-style-type: none">• Preparation of doors to commence Thursday, November 28, 2019.• Repainting of doors, frames and wall to commence December 2, 2019.• <u>Please remove all contents on the existing tack boards</u> Contractor will continue to remove tack boards.• Contractor will install temporary signage. <u>Please confirm all changes, if necessary, to the Project Manager, Tim Burchill tburchill@uvic.ca.</u> New permanent signage will be installed as a component of this project.
Time frame:	<p>Commencing Thursday, November 28, 2019</p> <p>**<u>SCHEDULE ATTACHED FOR YOUR REFERENCE</u></p>
FMGT contact:	Tim Burchill, Project Manager
Email address:	tburchill@uvic.ca
Phone:	250-472-5868



UVIC Clearhue Corridor Refresh

Phase Sequence

Floor	Phase	Start Date	End Date	Black out Dates	Notes
3	1	Fri. Nov. 08 / 19	Fri. Nov. 29 / 19		Project start - Mobilization on Friday Nov. 8th
1	2	Mon. Dec. 02 / 19	Fri. Dec. 13 / 19		1st floor work to be completed Over Christmas Break
1	3	Mon. Dec. 16 / 19	Thu. Jan. 02 / 20		1st floor work to be completed Over Christmas Break
2	4	Fri. Jan. 03 / 20	Fri. Jan. 17 / 20		
4	5	Mon. Jan. 20 / 20	Fri. Jan. 31 / 20		4th floor to be completed in Jan so it won't be affected by black out dates
3	6	Mon. Feb. 03 / 20	Fri. Feb. 14 / 20		
2	7	Mon. Feb. 17 / 20	Fri. Feb. 28 / 20		

Work Sequence

Client to remove anything to be retained prior to project

All existing whiteboards and tack boards to be removed in first 4 weeks of the project

All Signs will be removed and replaced with temporary signs in the first 4 weeks of the project

Door frames to be painted prior to walls - Each opening will take 3 days to complete - Once doors are complete doors can be closed and locked

New White boards will be installed in phase 1, 2, & 3 in the first 2 weeks in January - The remainder of white boards will be installed while phase is under construction

New Signage will be installed 8 weeks after the commencement of project and will continue till the completion of the project

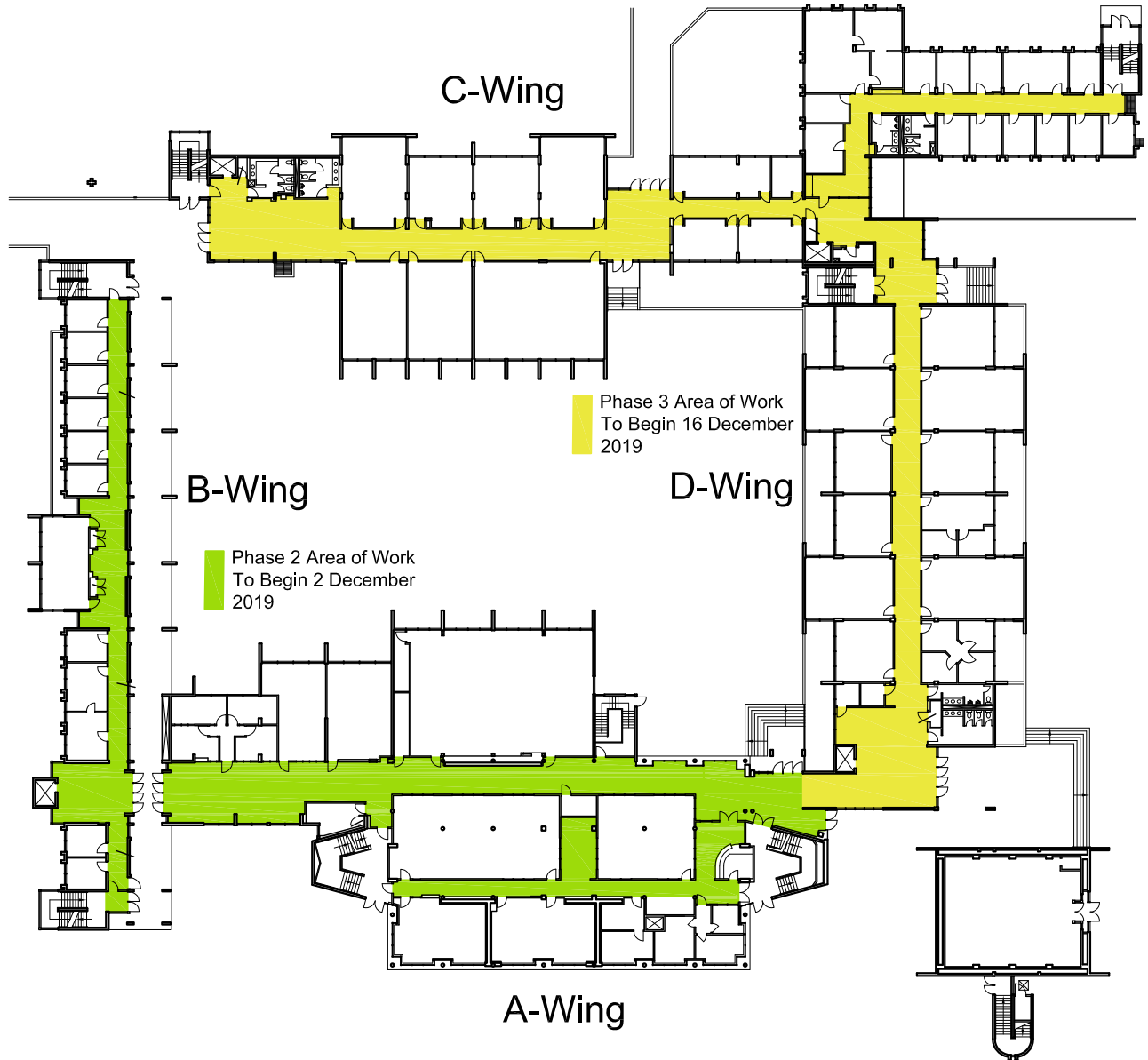
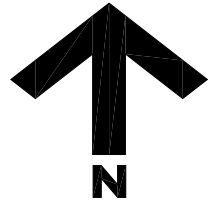

**University
of Victoria**

Facilities Management

Notes:

Title:
Clearihue Corridor Refresh
Level 1
Phasing Plan

Date: **6 November 2019**
Scale: **NTS**
Drawn By: **JW**
Project Number: **19-03923**
Drawing No. **SK1**

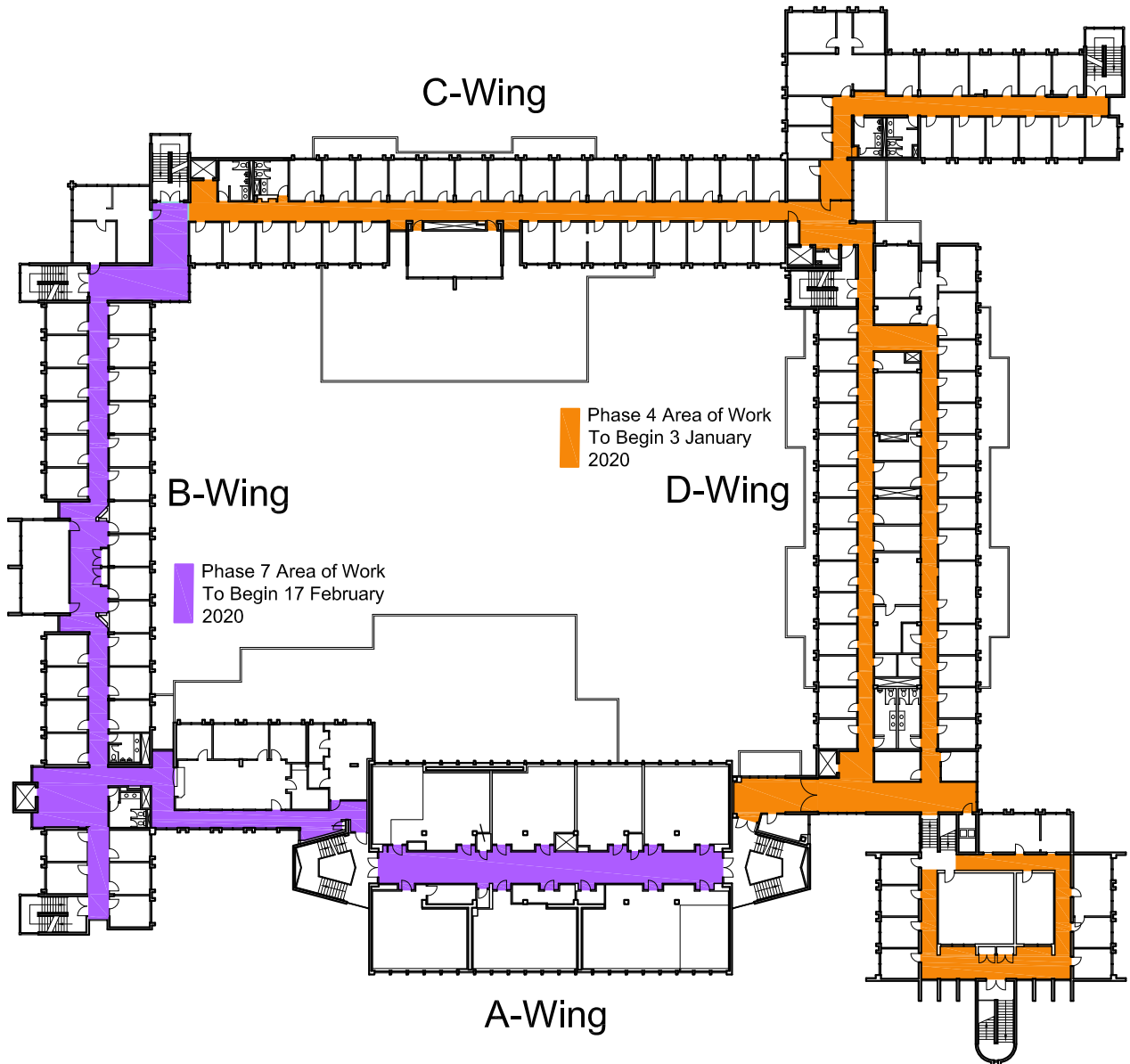
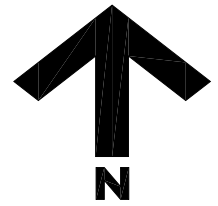

**University
of Victoria**

Facilities Management

Notes:

Title:
Clearihue Corridor Refresh
Level 2
Phasing Plan

Date: **7 November 2019**
Scale: **NTS**
Drawn By: **JW**
Project Number: **19-03923**
Drawing No. **SK2**

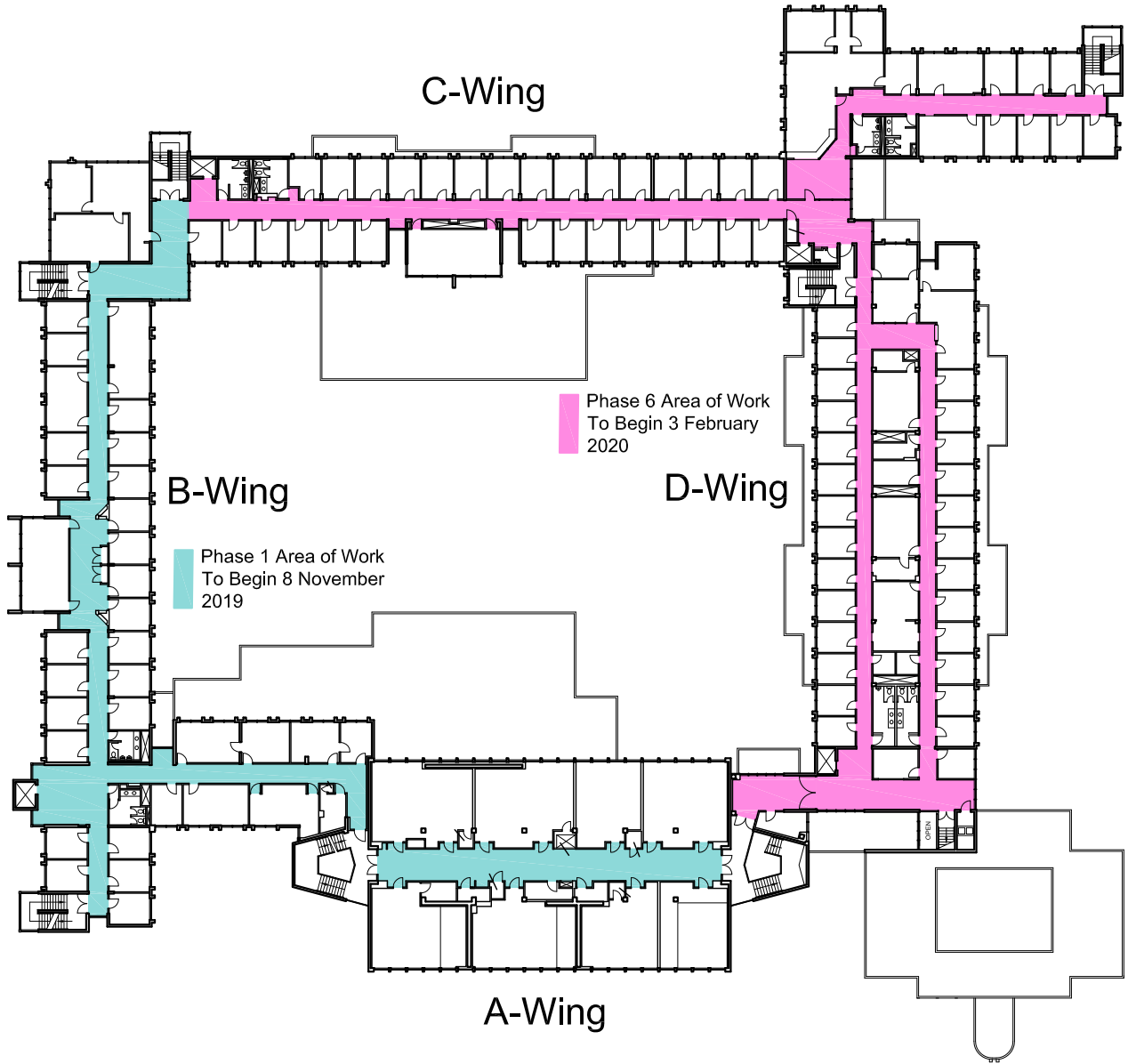
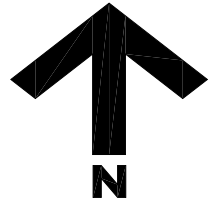

**University
of Victoria**

Facilities Management

Notes:

Title:
Clearihue Corridor Refresh
Level 3
Phasing Plan

Date: **7 November 2019**
Scale: **NTS**
Drawn By: **JW**
Project Number: **19-03923**
Drawing No. **SK3**

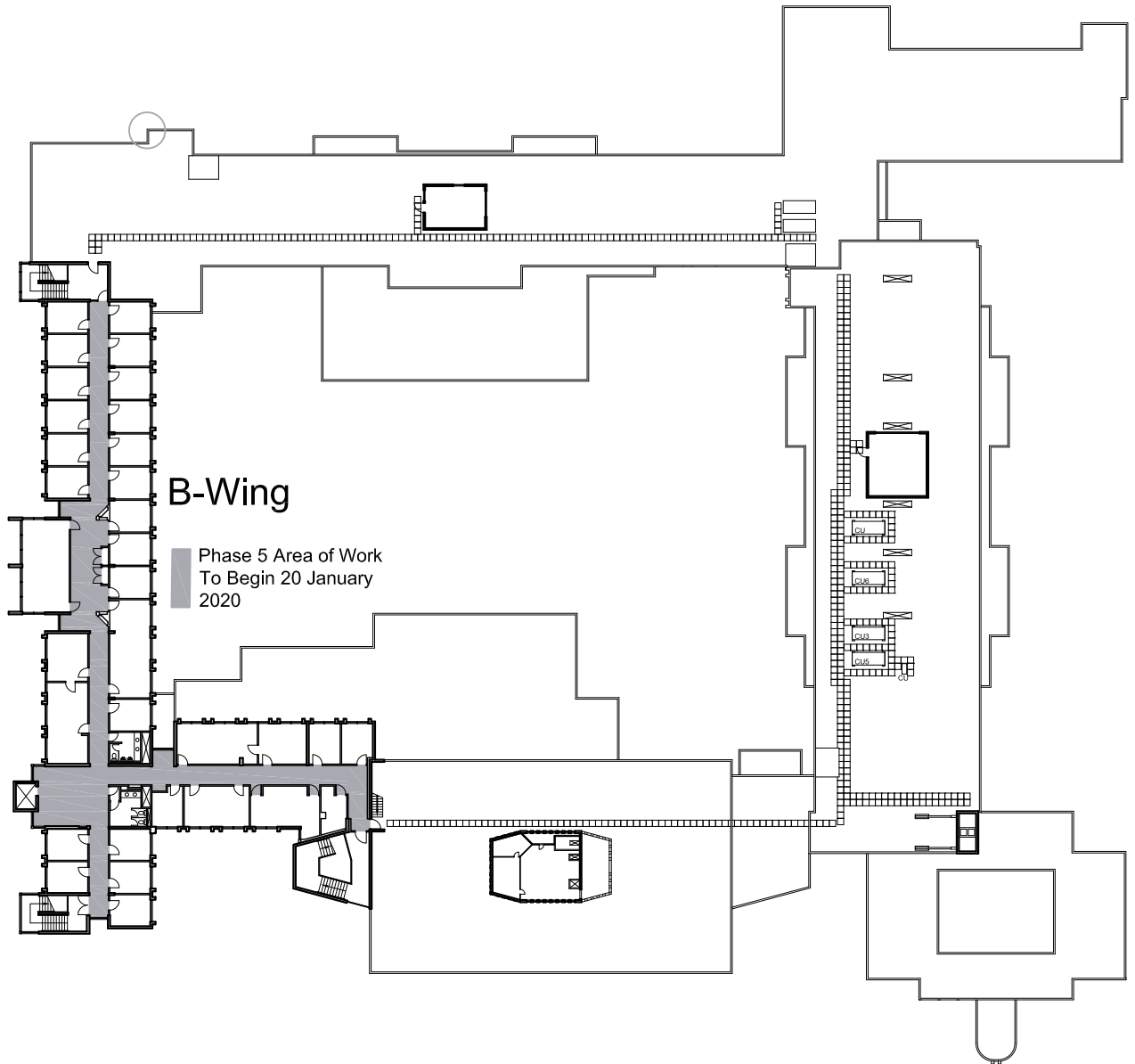
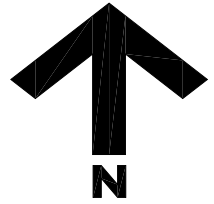

**University
of Victoria**

Facilities Management

Notes:

Title:
**Clearihue Corridor Refresh
Level 4
Phasing Plan**

Date: **6 November 2019**
Scale: **NTS**
Drawn By: **JW**
Project Number: **19-03923**
Drawing No. **SK4**