



# Facilities Notice

Capital Development & Delivery | Facilities Management  
Saunders Building, PO Box 1700 STN CSC Victoria BC V8W 2Y2 Canada  
T 250-721-7591 | [www.uvic.ca/fmgt](http://www.uvic.ca/fmgt)

---

**Title:** Tactile Warning Mats and Directional Indicators Installation

**Location:** Different locations on campus (see attached drawings).

**Description:** Facilities Management is working with G&E Contracting LP, on the installation of tactile warning mats and directional indicators on various campus sidewalks with completion targeted for February 24<sup>th</sup>, 2026.

Lanes will be closed (**one lane**) on Friday, February 20, 2026, at several locations for construction activities related to the installation of directional indicators.

We apologize for the inconvenience this may cause.

**Time frame:** Friday, February 20, 2026.

For specific lane closure times and location, please refer to the attached drawings.

**FMGT contact:** Tatiana Rios, Project Manager

**Email address:** [trios@uvic.ca](mailto:trios@uvic.ca)

**Phone:** 236-638-5387

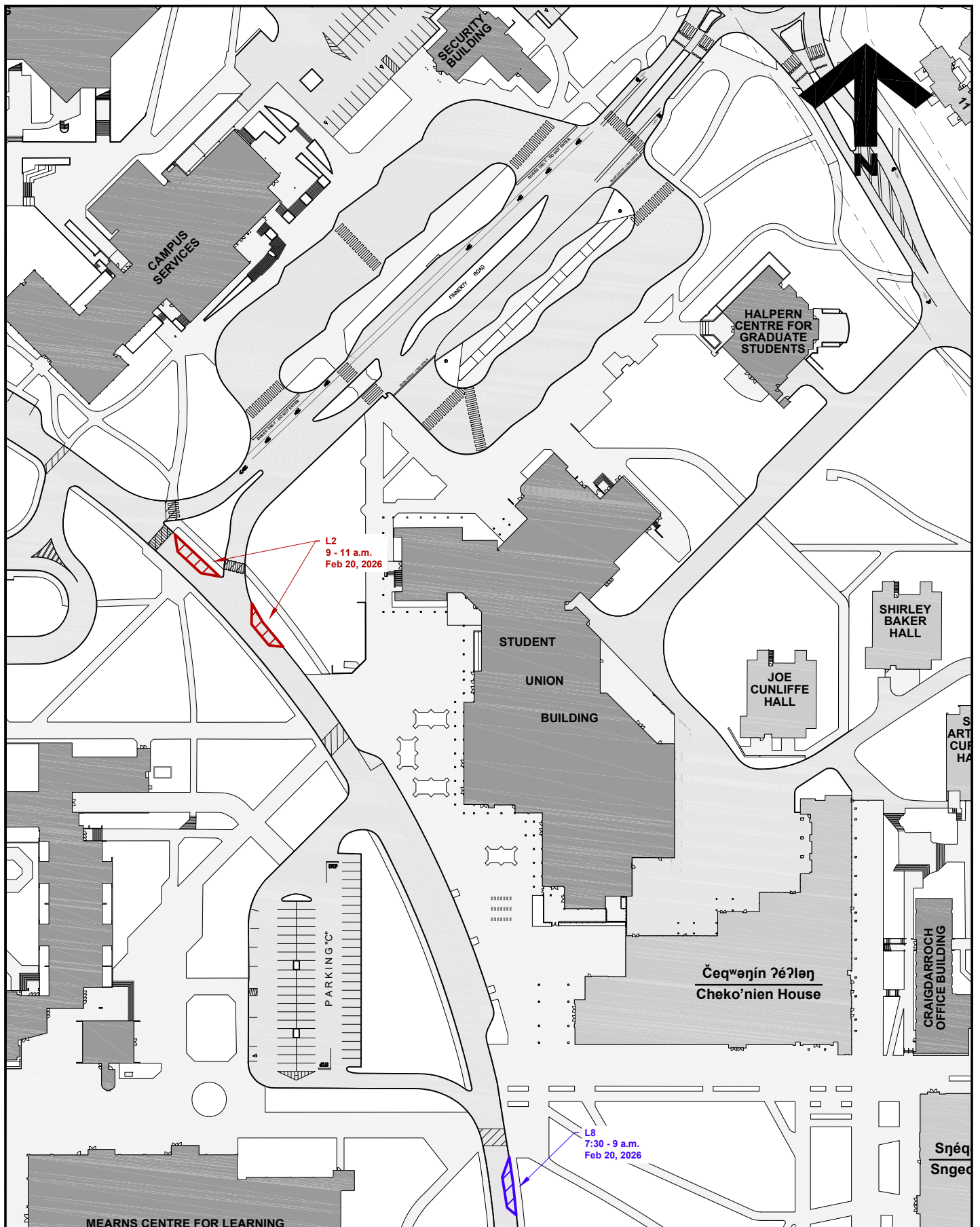

**University  
of Victoria**

**Facilities Management**

Notes:



**Lane Closure with  
Date and Time**

Title:

**Tactile Warning Mat**

**Installation**

**Project Notice**

**Bus Loop / Library Locations**

Date:

**18 February 2026**

Scale:

**1:1500**

Drawn By:

**JW**

Project Number:

**24-06401**

Drawing No.

**SK1**

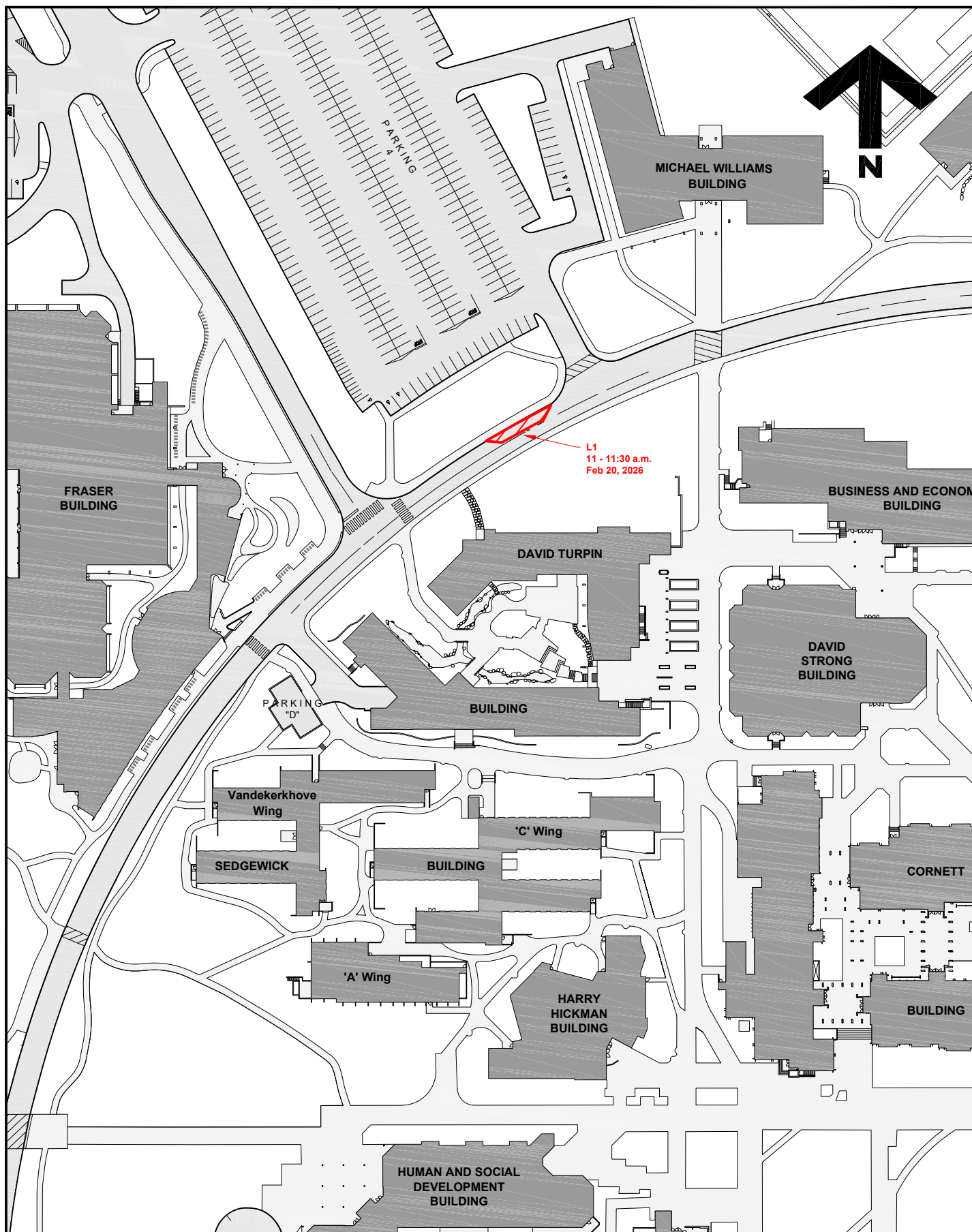
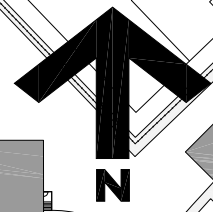

**University  
of Victoria**

**Facilities Management**

Notes:



**Lane Closure with  
Date and Time**

Title:

**Tactile Warning Mat**

**Installation**

**Project Notice**

**Location 1**

Date:

**18 February 2026**

Scale:

**1:1500**

Drawn By:

**JW**

Project Number:

**24-06401**

Drawing No.

**SK2**

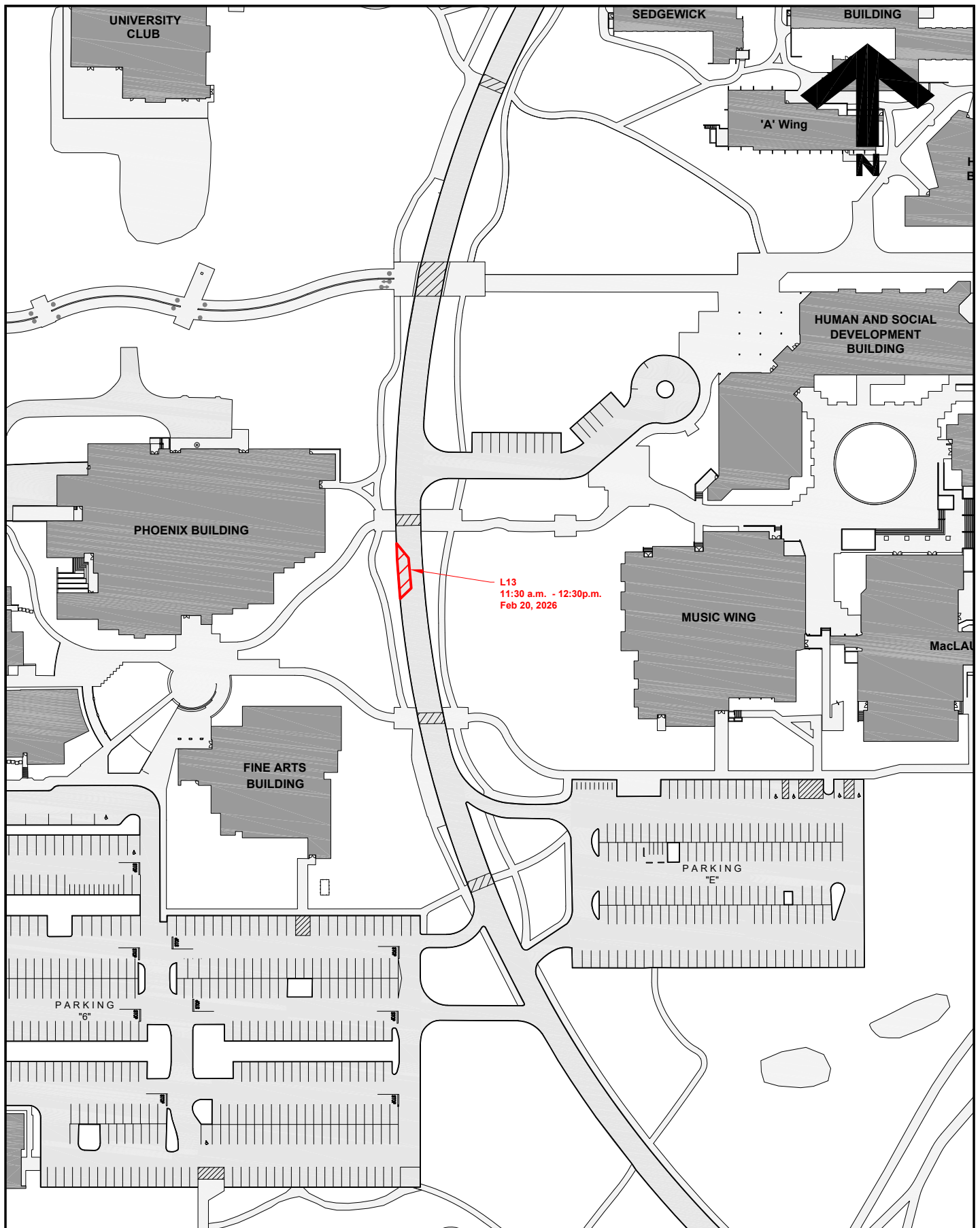

**University  
of Victoria**

**Facilities Management**

**Notes:**



**Lane Closure with  
Date and Time**

**Title:**

**Tactile Warning Mat**

**Installation**

**Project Notice**

**Location 13**

**Date:**

**18 February 2026**

**Scale:**

**1:1500**

**Drawn By:**

**JW**

**Project Number:**

**24-06401**

**Drawing No.**

**SK3**



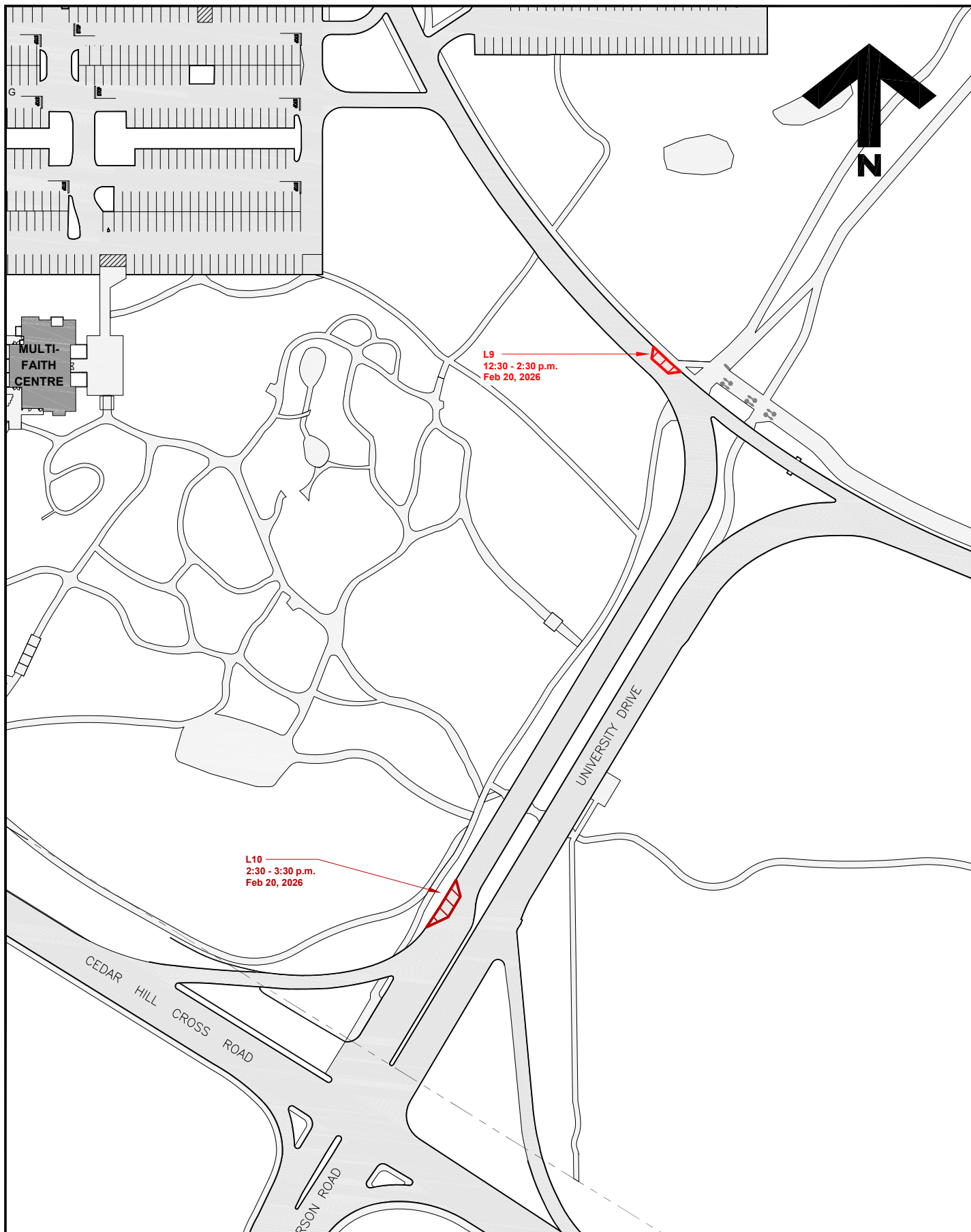

**University  
of Victoria**

Facilities Management

Notes:



Lane Closure with  
Date and Time

Title:

Tactile Warning Mat

Installation

Project Notice

Locations 9 & 10

Date:

18 February 2026

Scale:

1:1500

Drawn By:

JW

Project Number:

24-06401

Drawing No.

**SK4**