



# Facilities Notice

Capital Development & Delivery | Facilities Management  
Saunders Building, PO Box 1700 STN CSC Victoria BC V8W 2Y2 Canada  
T 250-721-7591 | [www.uvic.ca/fmgt](http://www.uvic.ca/fmgt)

---

<b>Title:</b>	Tactile Warning Mats and Directional Indicators Installation
<b>Location:</b>	Different locations on campus (see attached drawings).
<b>Description:</b>	<p>Facilities Management is working with G&amp;E Contracting LP, on the installation of tactile warning mats and directional indicators on various campus sidewalks with completion targeted for February 24<sup>th</sup>, 2026.</p> <p>Lanes will be closed (<b>one lane</b>) on Thursday, February 19, 2026, at several locations for construction activities related to concrete pouring and the Installation of tactile warning mats.</p> <p>We apologize for the inconvenience this may cause.</p>
<b>Time frame:</b>	<p>Thursday, February 19, 2026.</p> <p>For specific lane closure times and location, please refer to the attached drawings.</p>
<b>FMGT contact:</b>	Tatiana Rios, Project Manager
<b>Email address:</b>	<a href="mailto:trios@uvic.ca">trios@uvic.ca</a>
<b>Phone:</b>	236-638-5387

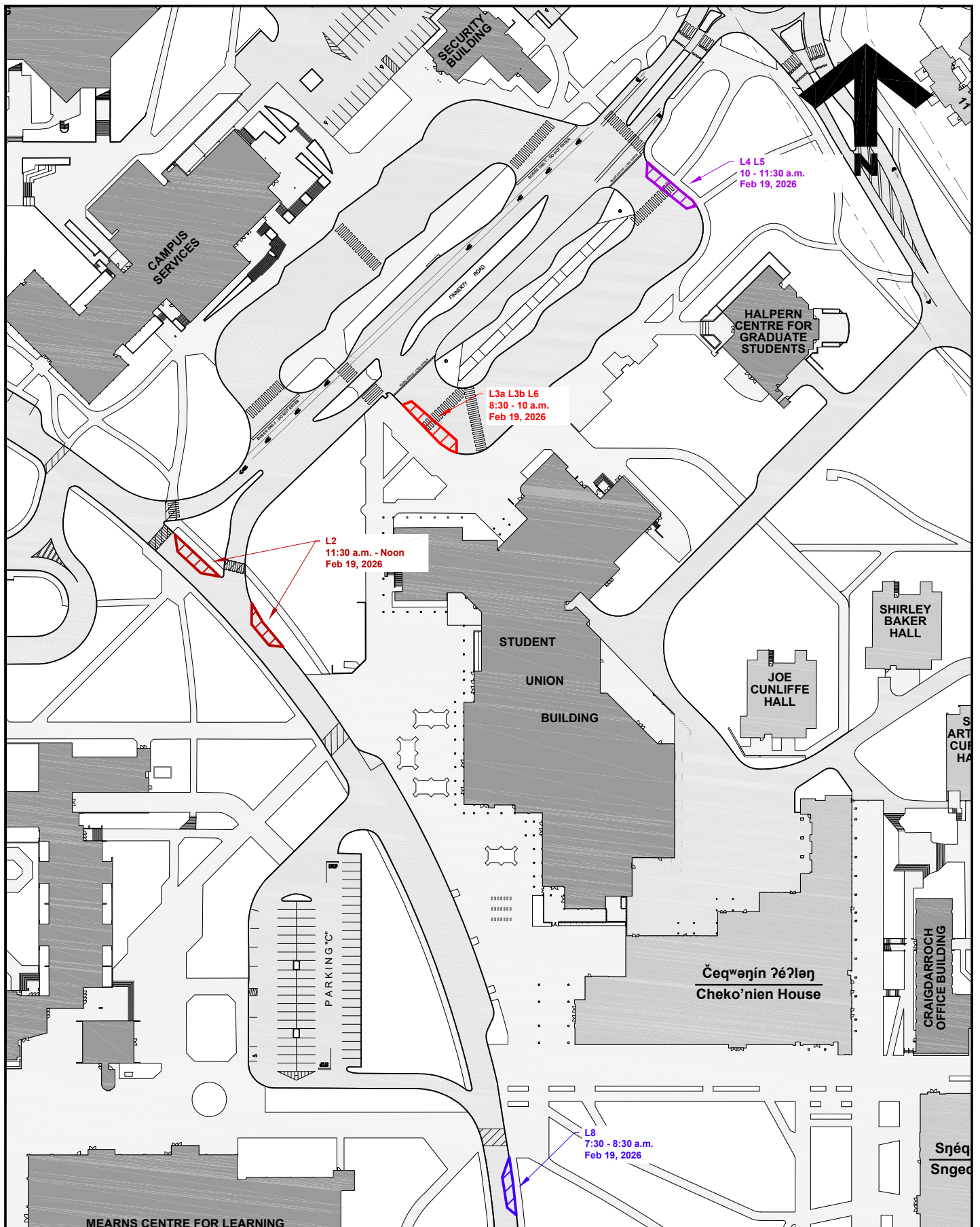

**University  
of Victoria**

Facilities Management

Notes:



Lane Closure with  
Date and Time

Title:

Tactile Warning Mat

Installation

Project Notice

Bus Loop / Library Locations

Date:

17 February 2026

Scale:

1:1500

Drawn By:

JW

Project Number:

24-06401

Drawing No.

**SK1**

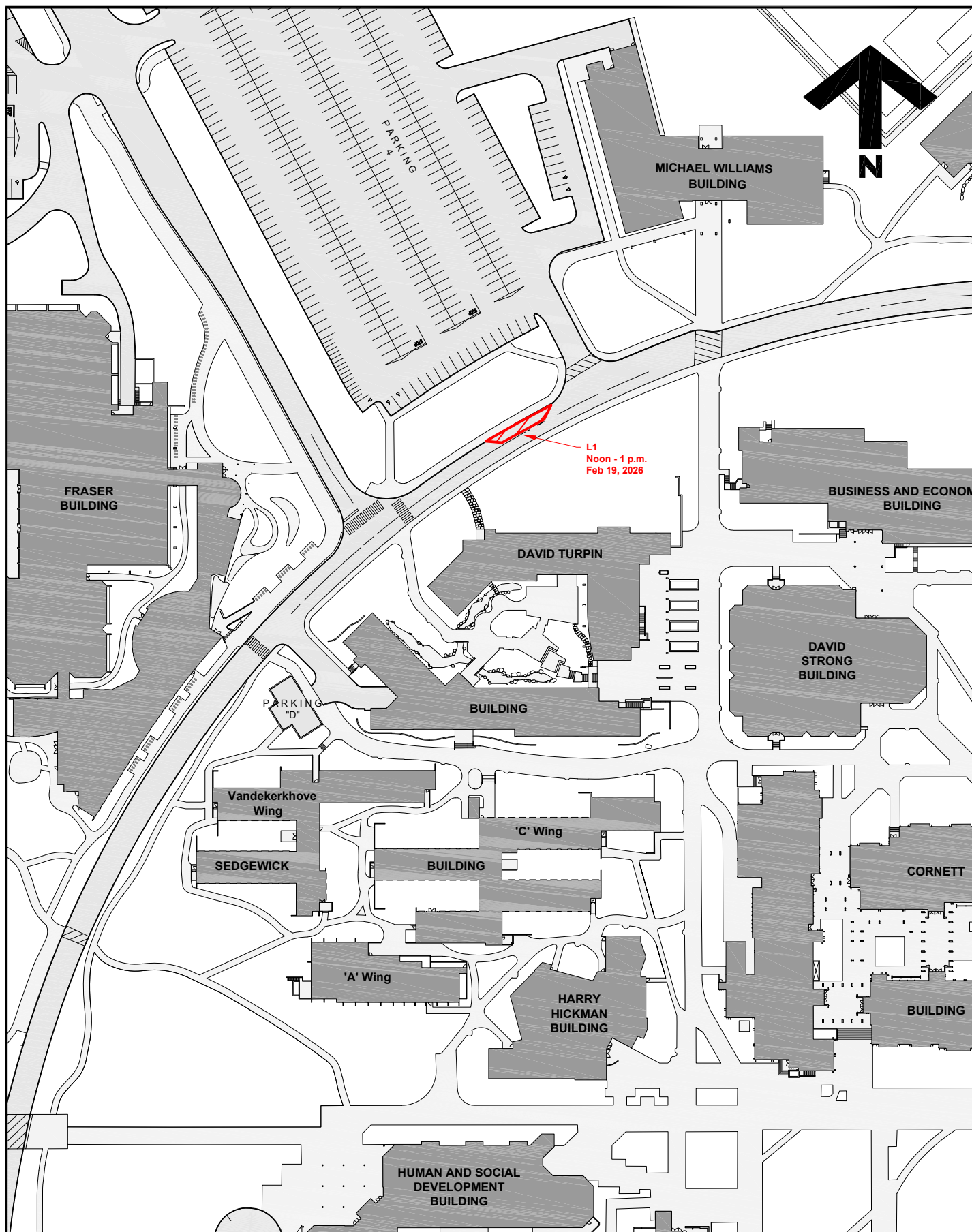
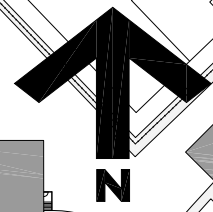

**University  
of Victoria**

**Facilities Management**

Notes:



**Lane Closure with  
Date and Time**

Title:

**Tactile Warning Mat**

**Installation**

**Project Notice**

**Location 1**

Date:

**17 February 2026**

Scale:

**1:1500**

Drawn By:

**JW**

Project Number:

**24-06401**

Drawing No.

**SK2**

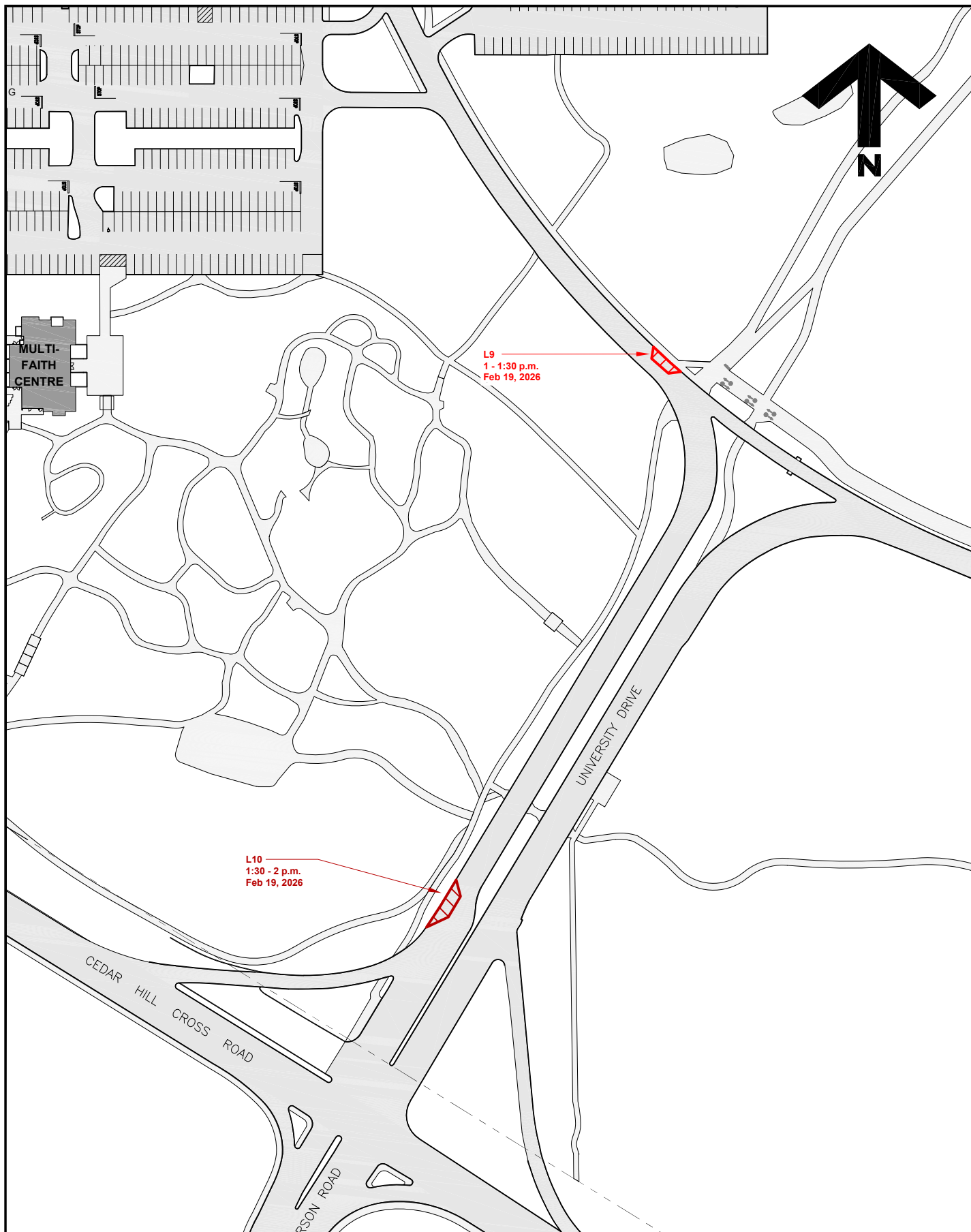

**University  
of Victoria**

Facilities Management

Notes:



Lane Closure with  
Date and Time

Title:

Tactile Warning Mat

Installation

Project Notice

Locations 9 & 10

Date:

17 February 2026

Scale:

1:1500

Drawn By:

JW

Project Number:

24-06401

Drawing No.

**SK3**



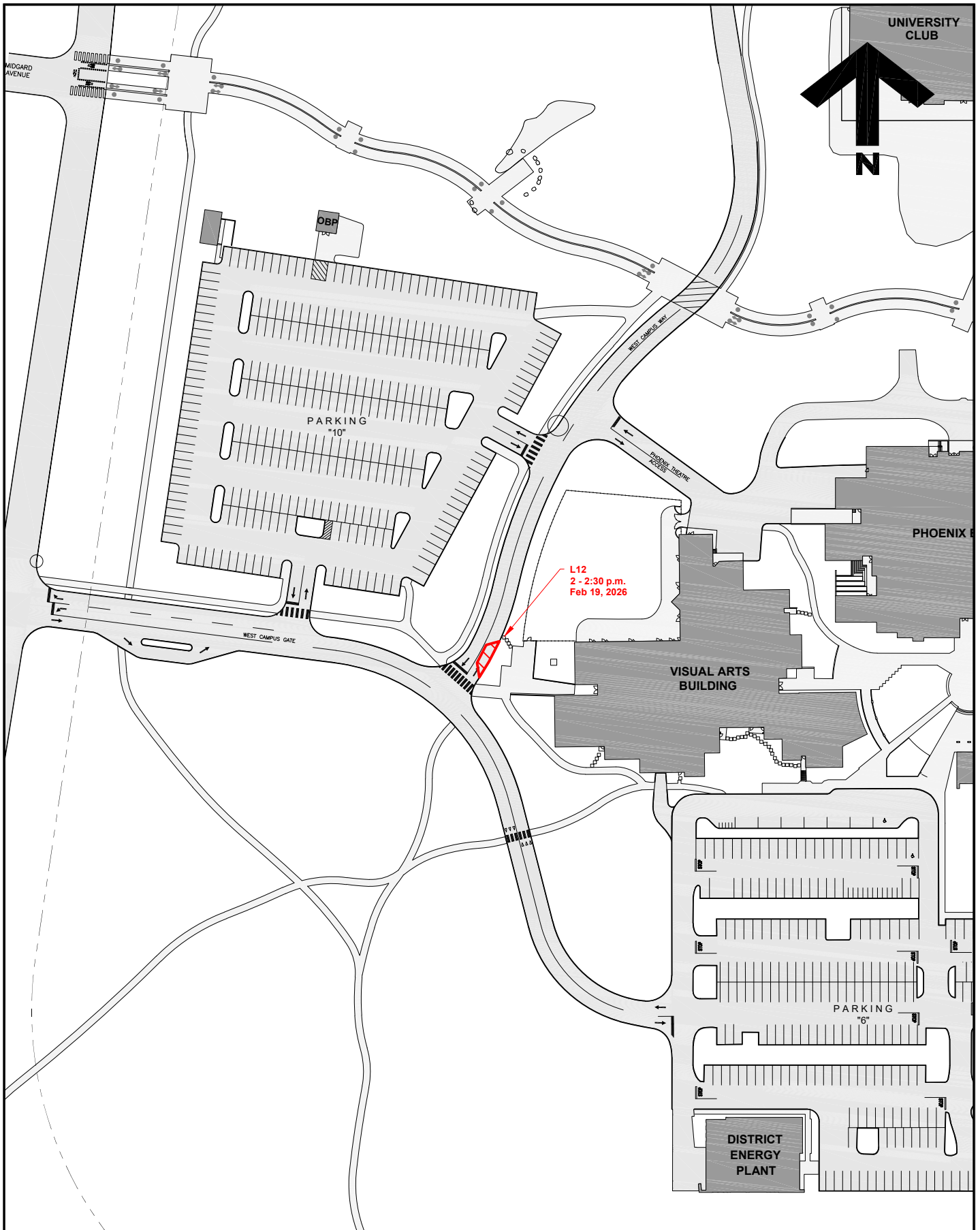

**University  
of Victoria**

**Facilities Management**

Notes:

 **Lane Closure with  
Date and Time**

Title:

**Tactile Warning Mat**

**Installation**

**Project Notice**

**Location 12**

Date: **17 February 2026**

Scale: **1:1500**

Drawn By: **JW**

Project Number: **24-06401**

Drawing No. **SK4**